

IT - ISTRUZIONI MONTAGGIO

EN - SET UP INSTRUCTIONS

FR - INSTRUCTIONS MONTAGE

ES - INSTRUCCIONES DE MONTAJE

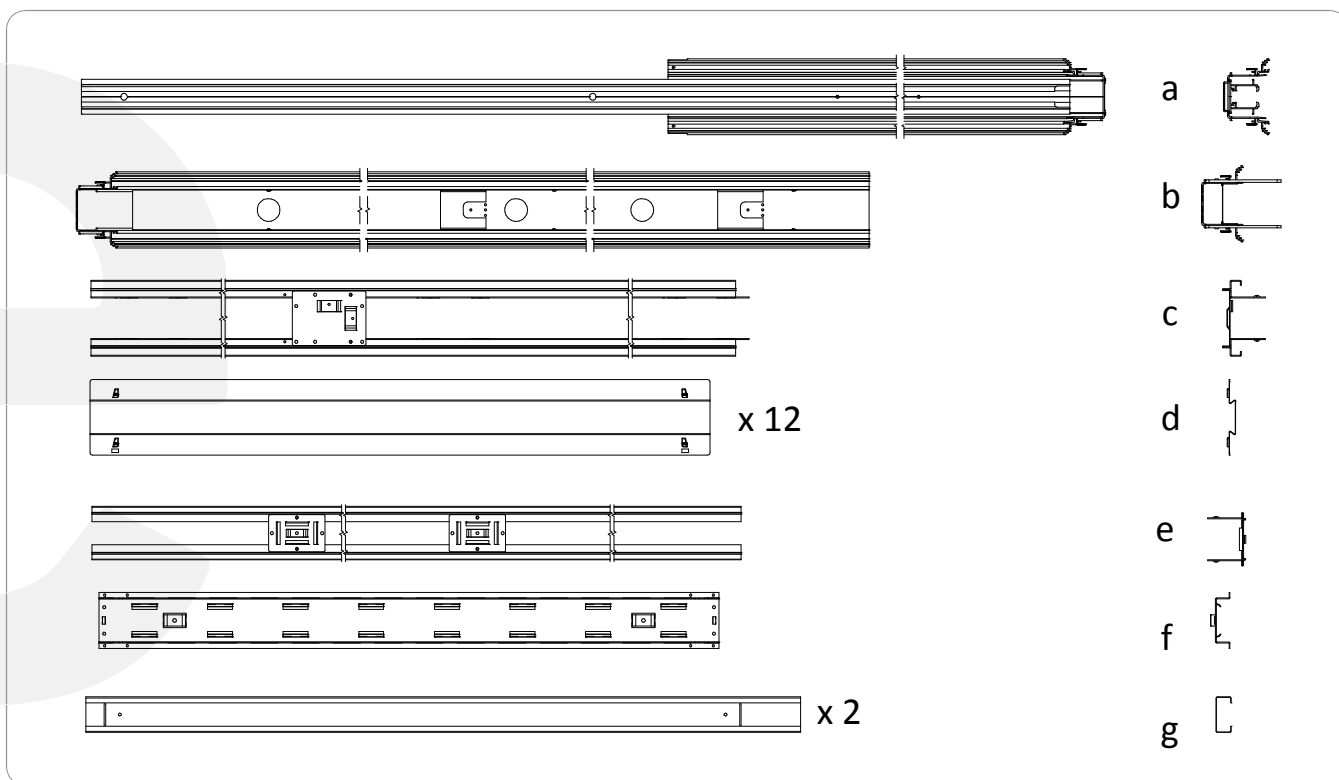
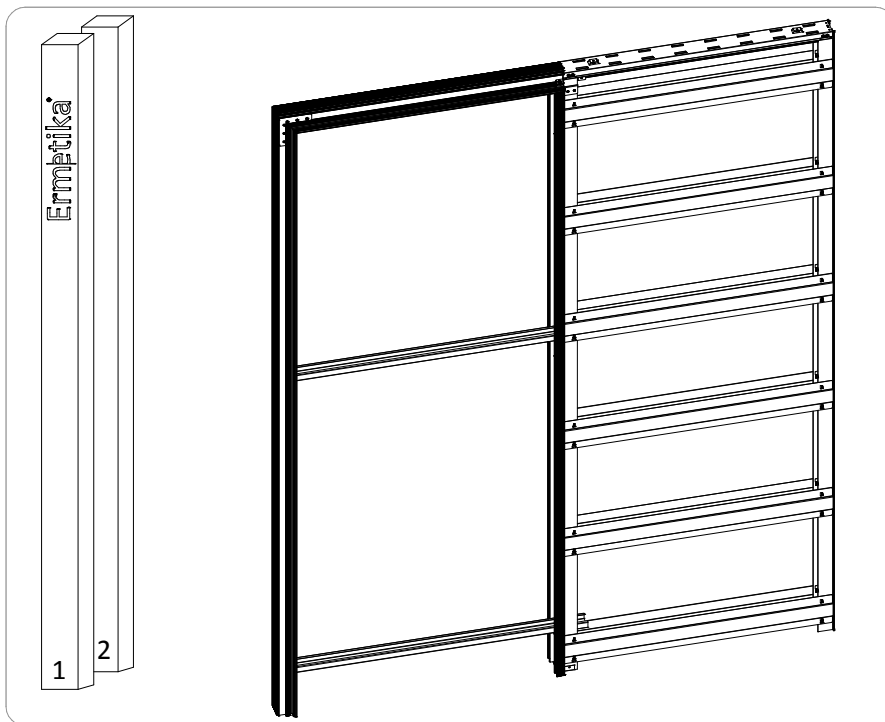

Dotazione - Standard equipment - Equipement standard - Equipo standard



v1 = n° 6x 3,9x13



v2 = n° 8x 4,8x9,5



v3 = n° 2x 4,8x25

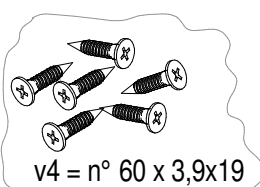

v4 = n° 60 x 3,9x19



x 2



x 1



x 2



x 2

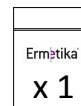

Kit carrello
Track kit
Kit chariot
Kit carros

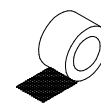

20 mt/l

1

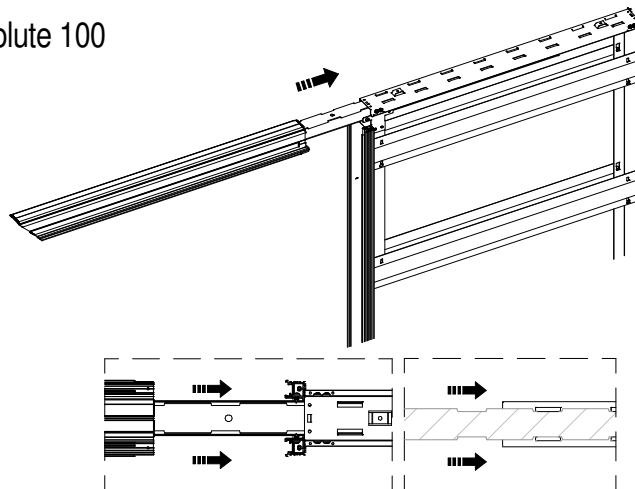
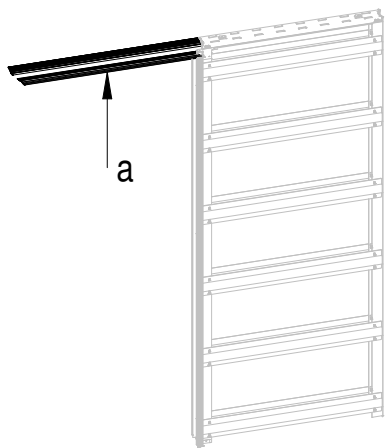

2

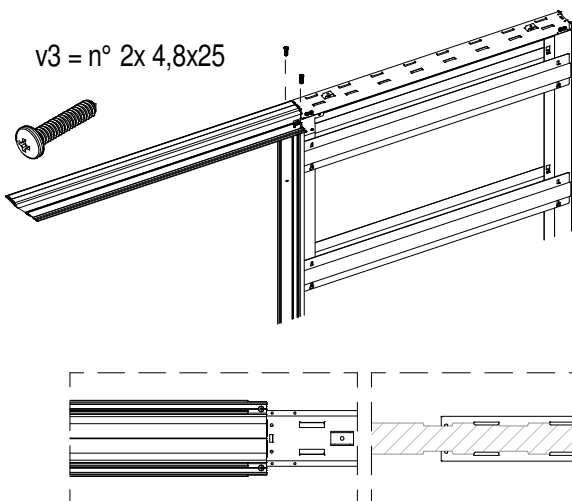
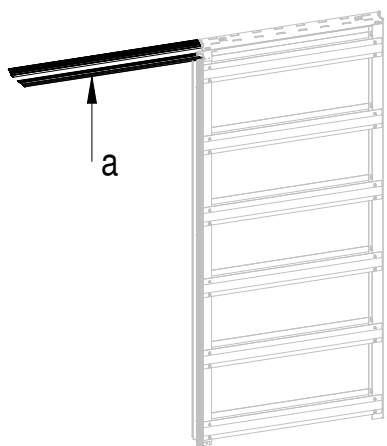

3

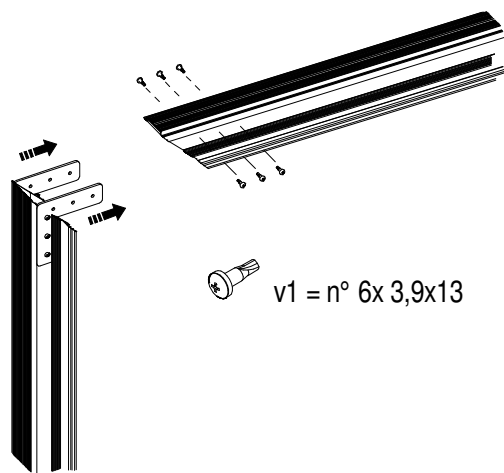
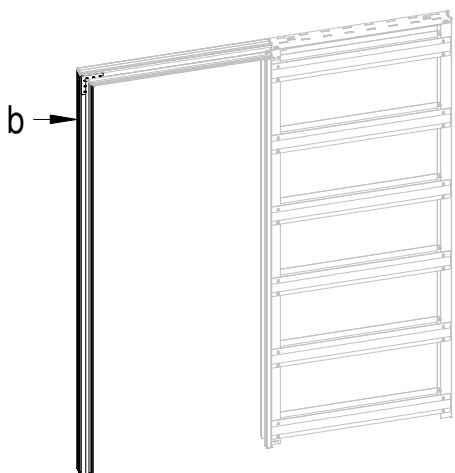

4

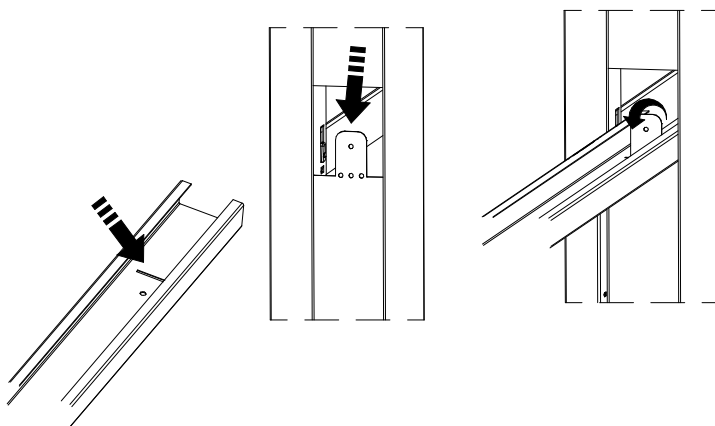
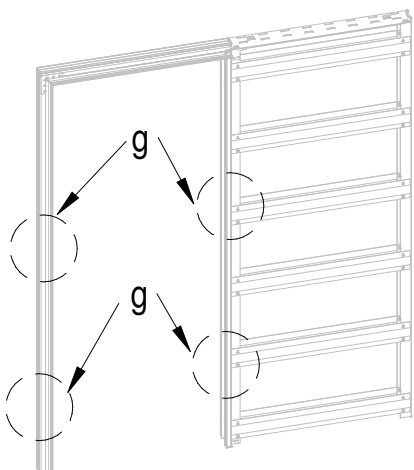

Evokit Absolute 100

Posizionamento su tramezzo - Framing -
Installation sur structure placo - Fijacion de la estructura

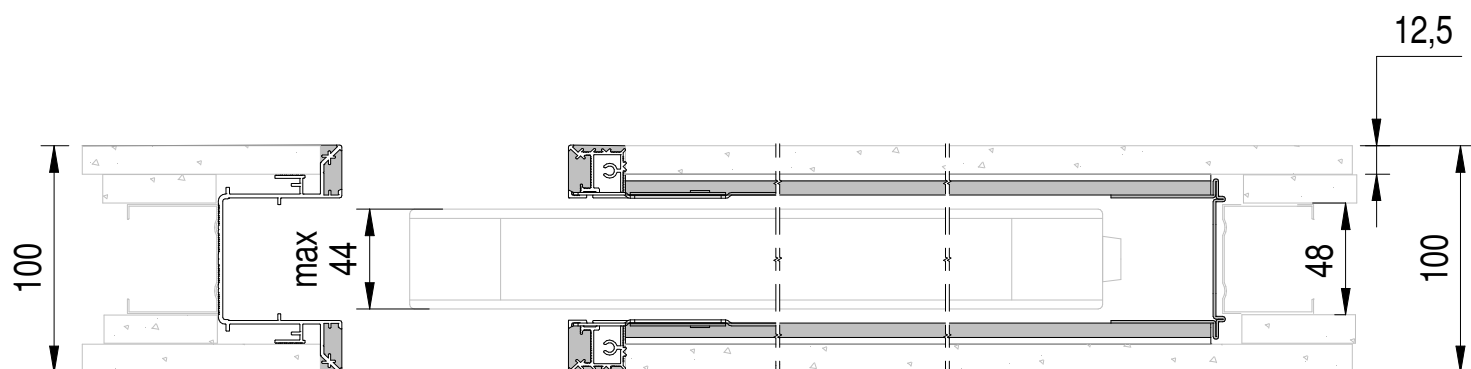
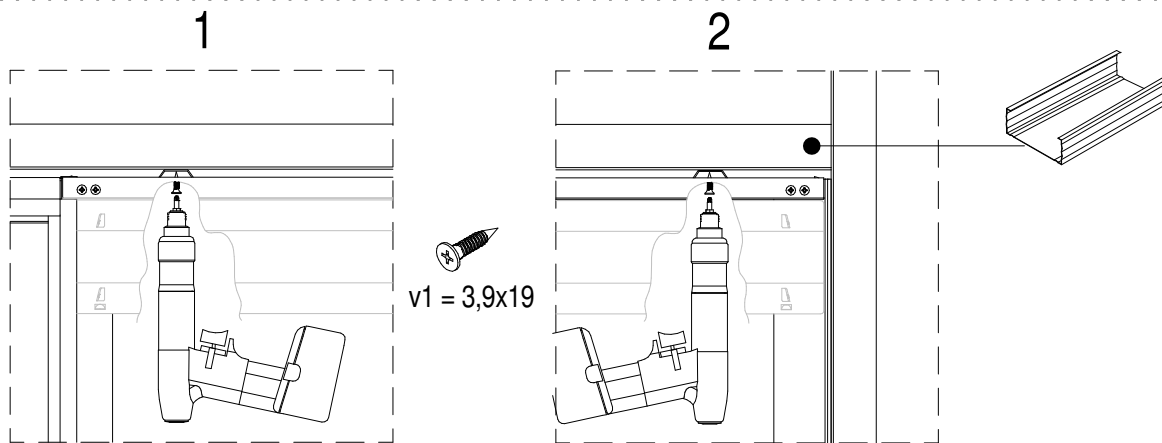
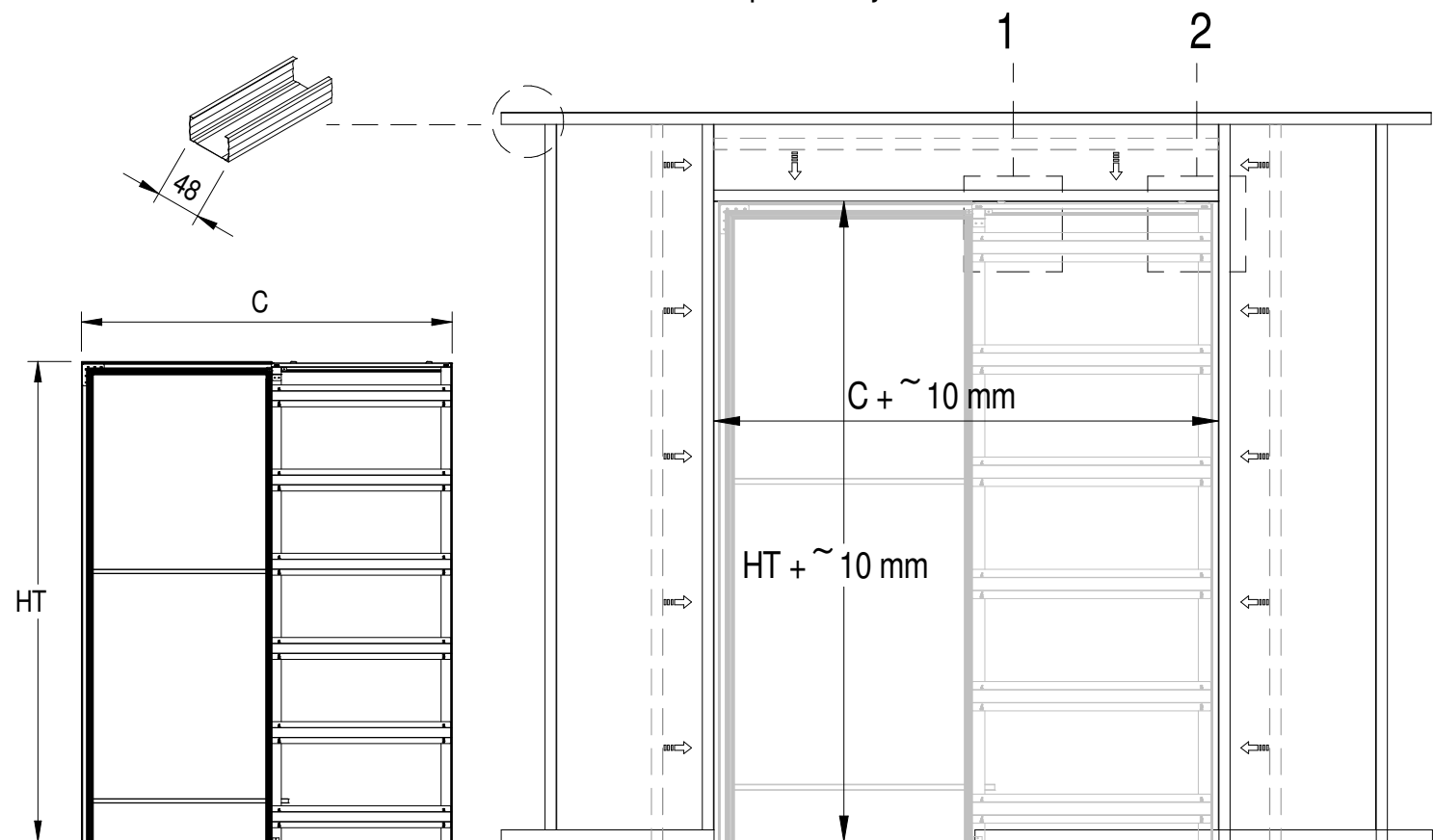

- STUCCATURA PERIMETRO - PERIMETER PLASTER COATING -
 - APPLICATION PLATRE - APLICACION ESCAYOLA

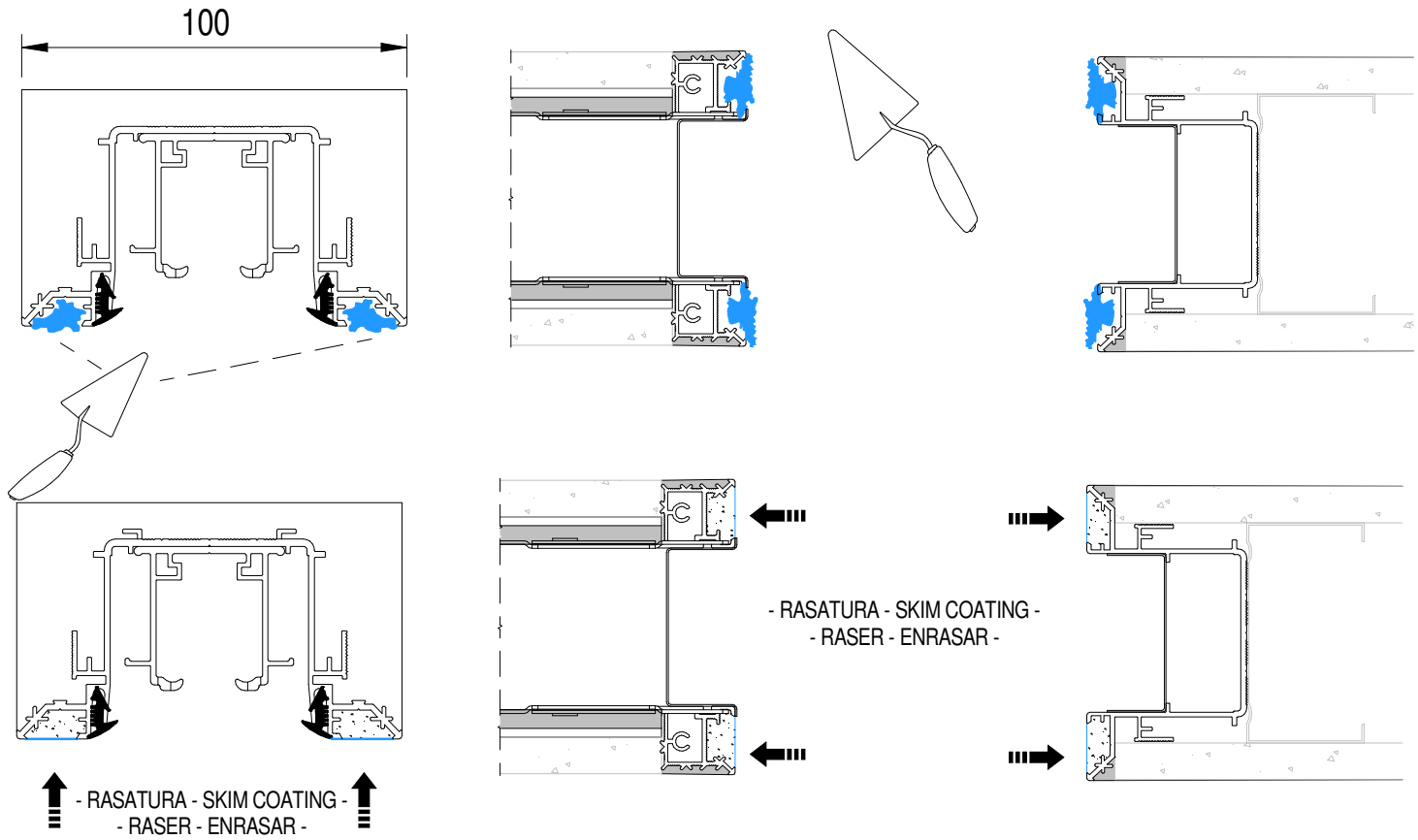

IT - Rimuovere i distanziali solo dopo la perfetta seccatura del cemento
EN - Take apart the spacers when the mortar is completely dry
FR - Détacher les entretoises une fois l'enduit seche
ES - Remover los distánciales cuando el revoque está seco

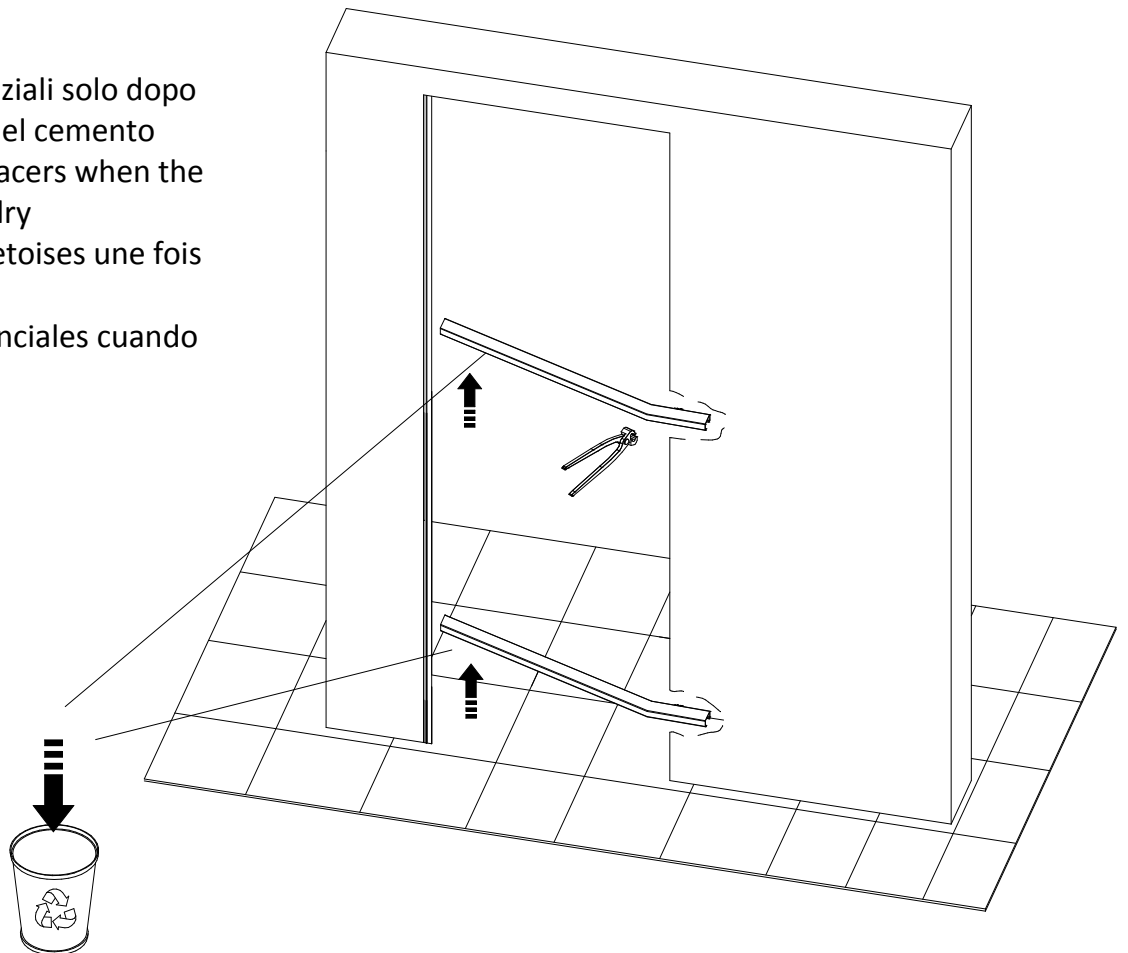

APPLICAZIONE RETE PER STUCCATURA - APPLICATION OF FINISHING MESH TAPE - APPLICATION
DE LA BANDE DE RENFORT FOURNIE - APLICACION DE LA MALLA PARA JUNTAS

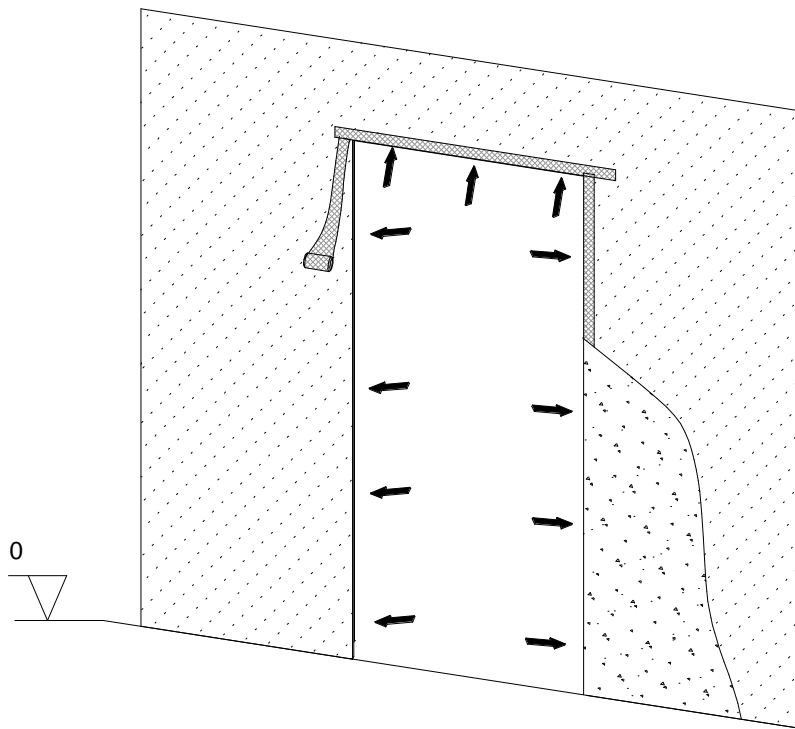

- IT** - Applicare sul perimetro la rete a maglia 3x3 in dotazione prima della stuccatura
EN - Apply the fiber net 3x3 supplied before finishing
FR - Appliquer la bande de renfort fournie avant de plâtrer
ES - Aplicar la red de refuerzo suministrada antes de la aplicación del mortero

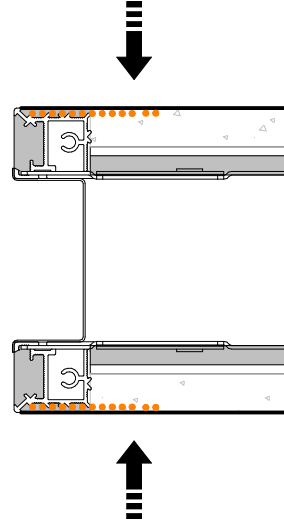
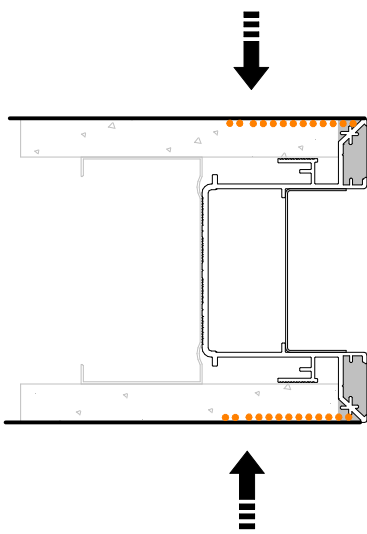

IT - E' consigliabile l'uso di stucco fibrato nella zona perimetrale

EN - Fiber-reinforced joint filler for the perimeter zone can be advisable

FR - L'enduit de rebouchage fibré est particulièrement approprié au périmètre

ES - Resulta especialmente apropiado el uso de masilla reforzada en el perímetro

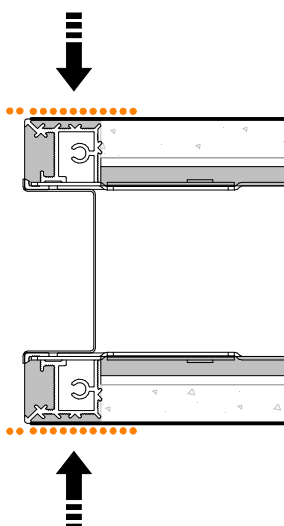
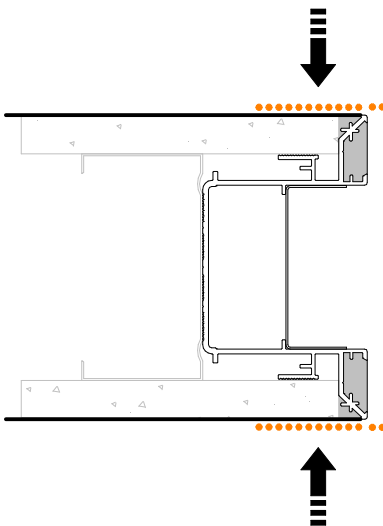

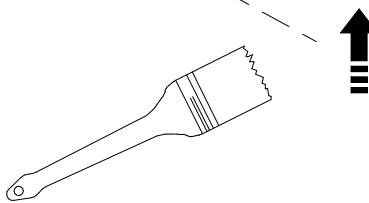
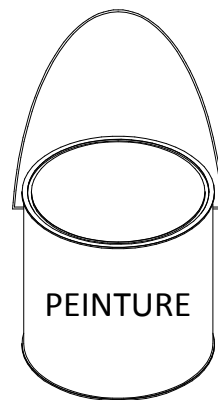
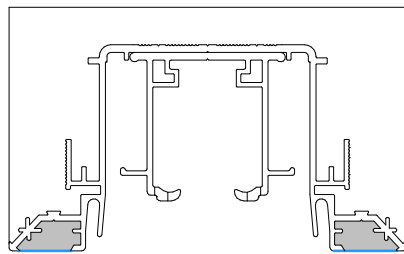
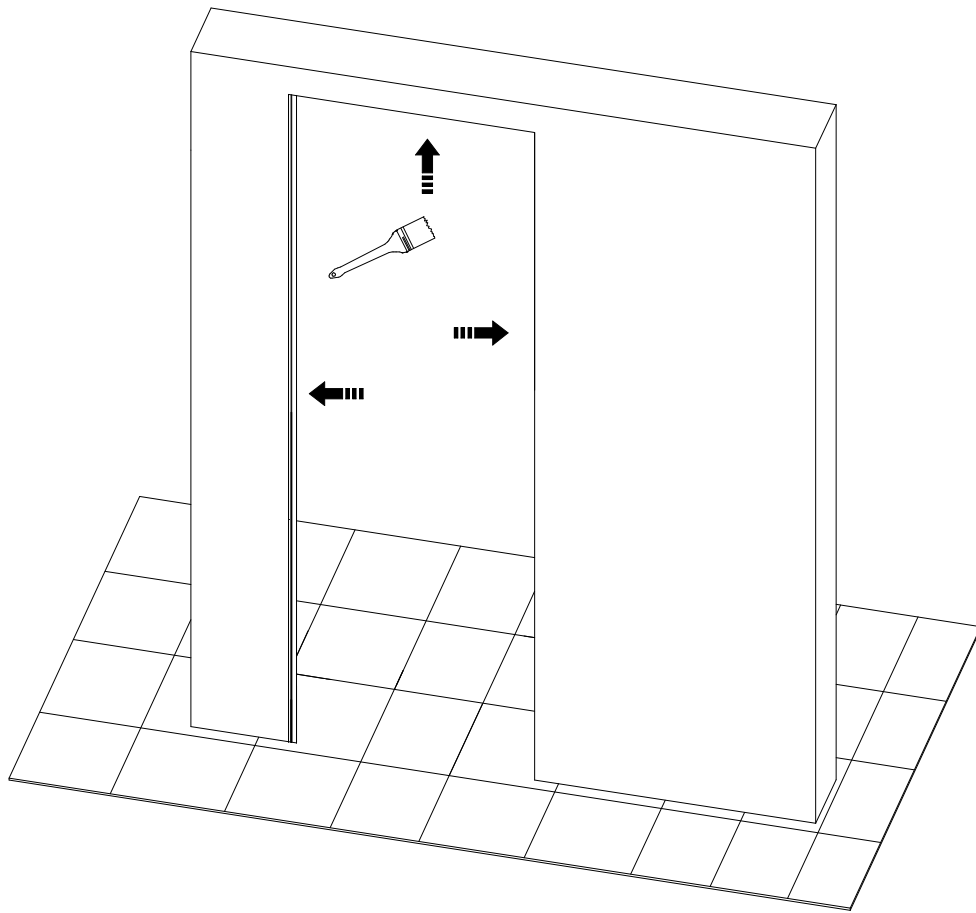

Ermetika
LIVE YOUR SPACE



+39 0883 535781



tecnico@ermetika.it



www.ermetika.it